

M5 4Pin female panel connector, rear fastening, soldered with 30cm 26AWG PVC wires

Please be informed that the data shown in this PDF document is generated from our Online Catalog for reference only, for detailed technical information please contact our sales!

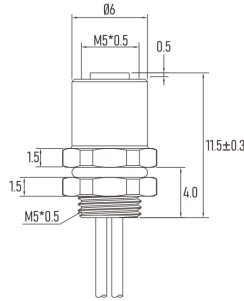

Part No.: MA04P4LSAB26W03

Contacts Poles: 04 Pin

Connector Gender: Female connector

Current Rating: 1 A

Wire Gauge (size): 26AWG/ 0.14mm²

Keyway Coding: A-Coding

Product data

Contacts Poles:	04 Pin	Cable Length:	30 cm
Connector Gender:	Female connector	Current Rating:	1 A
Wire Gauge (size):	26AWG/ 0.14mm ²	Voltage Rating:	60V
Wire Insulation:	PVC	Keyway Coding:	A-Coding
Straight/ 90° Angled:	180° Straight	Contacts Termination:	Soldering
Temperature Rating:	-20°C ~ + 80°C	Contacts Material:	Brass, machined solid pin
Cable Flamability:	VW-1	Contacts Plating:	3μ" Gold plating thickness
Inserts:	TPU + GF	Sealing:	O-Ring
Locking Screws:	Brass with nickel plated	Contact Resistance:	≤10mΩ
Panel Cut Size:	M5x0.5	Insulation Resistance:	≥ 100 MΩ
Protection Degree:	IP 67	Pollution Degree:	III
Connector Flamability:	UL94 HB	Waterproof Depth:	IP67 1m depth 30 minutes
Plug Mating Life:	100 times	Warranty:	2-years quality guarantee period
Compliance:	RoHS compliant	Reference Standard:	IEC 61076-2-105
Connector Type:	Panel mount receptacle		

Description

M5 circular connector is specially developed for the miniature sensor market and any application that requires multiple sensors within a very small area. The product line offers 3 and 4 Pins cable cord-sets and a range of panel-mounted receptacles. All connectors are either factory PVC/PUR over-molded or panel receptacles supplied with single wires or PCB solder pins, which is very compact and convenient for the application in narrow installment places.

- Cable plugs and panel receptacles are available
- Cable length base on customer requesting
- TPU over molded, IP67 protection degree
- 3, 4 poles per connector are available
- Operating voltage 60V, current 1A