

M12 A-Code male panel connector, front side fastening, PCB Contacts, Plastic Screw

M12 A-型 公头 板端连接器 板前锁 塑胶螺丝 PCB型

Front Fastened 前锁

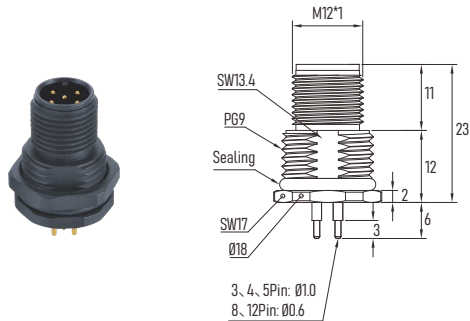

Recommended Panel Cut-out 面板开孔建议

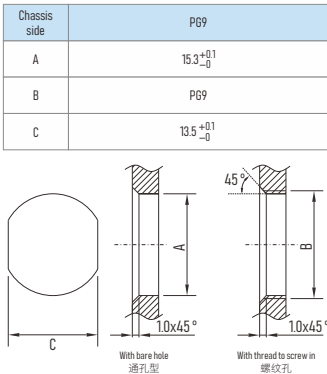

Connector Technical data 技术参数

Contacts No. Pin位/芯数	3Pin	4Pin	5Pin	8Pin	12Pin
Front View 正视图					
Reference Standard 参照标准	IEC 61076-2-101				
Rated current 额定电流	4A			2A	1.5A
Rated voltage 额定电压	250V			30V	500V
Impulse voltage 脉冲高压	2500V			800V	500V
Locking system 锁紧方式	M12 x 1.0 screw / M12 螺丝锁紧				
Tightening Torque 螺丝扭矩	Recommend/ 建议:0.6Nm, Max/ 最大:1.0Nm				
Termination 接线方式	PCB Dip Soldering / PCB浸焊				
Rated temperature 温度范围	-25 °C ... +80 °C; - 40 °C ... +105 °C				
Insulation resistance 绝缘电阻	≥100MΩ				
Contact resistance 接触电阻	≤5mΩ				
Contact carrier 胶芯材料	PA66 + GF				
Screw nut 螺丝材料	PA66 + GF				
Contact Pin针端子	Brass 黄铜				
Contacts plating 端子镀层	Au (Gold) 镀金				
O-ring 密封圈	FKM/ Silicon 氟橡胶/硅胶				
Protection degree 防护等级	IP67, IP68				
Pollution degree 污染等级	3				

Ordering No. 订购料号

Poles 芯数	Panel Front Side Fastening 板前锁
3 Pin	MC03P1LPAPP9
4 Pin	MC04P1LPAPP9
5 Pin	MC05P1LPAPP9
8 Pin	MC08P1LPAPP9
12 Pin	MC12P1LPAPP9

PCB Layout Reference 孔位分布与钻孔建议

